

The manual pull cord pack consists of 3 pieces:

- Main pull cord mechanism
- Cord tensioner
- Back plate

Attaching the control:

1. Position the magnetic control on the plate, moving the cord to put the two magnets in phase
2. Take off the control, and remove the protection from the adhesive coating on the plate and on the control. Attach the control, centring it with the collar on the plate itself, making the long side perfectly parallel with the nearby glass retaining bead on the window frame
3. Press the control firmly against the plate

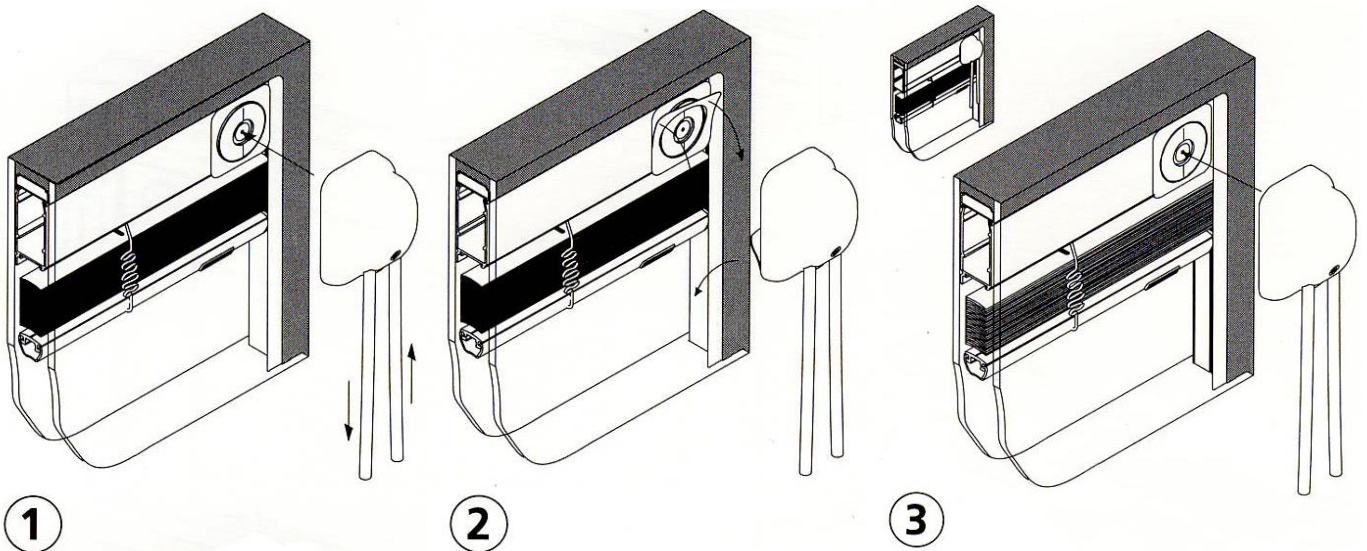

Attaching the cord tensioner:

4. Peel off the protection from the adhesive on the back of the cord tensioner
5. Hook the cord loop over its runner on the cord tensioner
6. Maintain a slight tension on the cord, with the cord tensioner slider halfway
7. Attach the cord tensioner to the glass with suitable pressure, taking care to position it parallel to the frame and in line with the control
8. Pull cord to left / right to tilt or raise

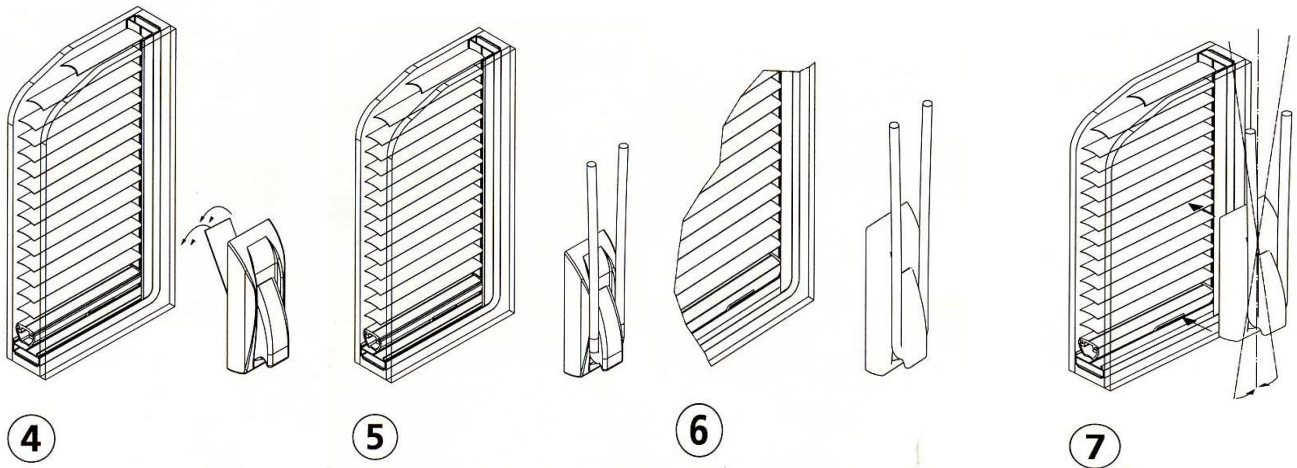

Should you require any further information please do not hesitate to contact us on:

E-mail: info@ravensbyglass.co.uk