

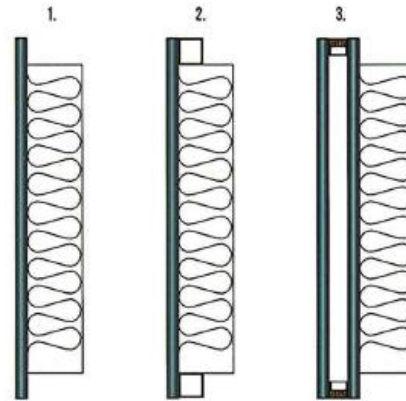

Ceramic enamel frit is applied to annealed glass via our automatic spray system. Available in most RAL and BS colours. The coated glass is then heated to about 690 degrees celsius, fusing the frit to the glass surface, which produces a ceramic coating almost as hard and tough as the glass itself. Glass can also be Heat Soaked if required.

Some of the standard constructions are:



1. Single Ceramic with stepped insulation for glazing directly into a single glazing rebate.
2. Single Ceramic with stepped insulation and an aluminium channel to fit an insulating rebate.
3. Insulated Ceramic with stepped insulation.

Benefits include:

- Total concealment of internal structure or services.
- Provide uniformity of curtain walling appearance.
- Free from discolouration by internal condensation or deposit of volatiles and no colour fading.
- Insulated panels can be provided.
- Ease of installation and minimal maintenance.
- Available toughened to EN 12150: EN 14179.
- Impact Classification 1.
- Resistance to corrosion.



Ceramic Spandrel panels are used in place of glazing units in curtain walling systems where it is necessary to hide the edges of floors slabs, ceiling details, insulation and other building elements that would ruin the look of the building if they were exposed.

Spandrel Panels are not designed to be viewed in transmitted light, they must be used against a backup wall. If no backup wall is present, a decorative tray needs to be applied.

A fired ceramic frit is durable and resists scratching, chipping, peeling, fading and chemical attacks and is approved by structural silicone manufacturers for bonding to glass.